

KN VKX-serie kølebeholder i rustfri stål m. isolering

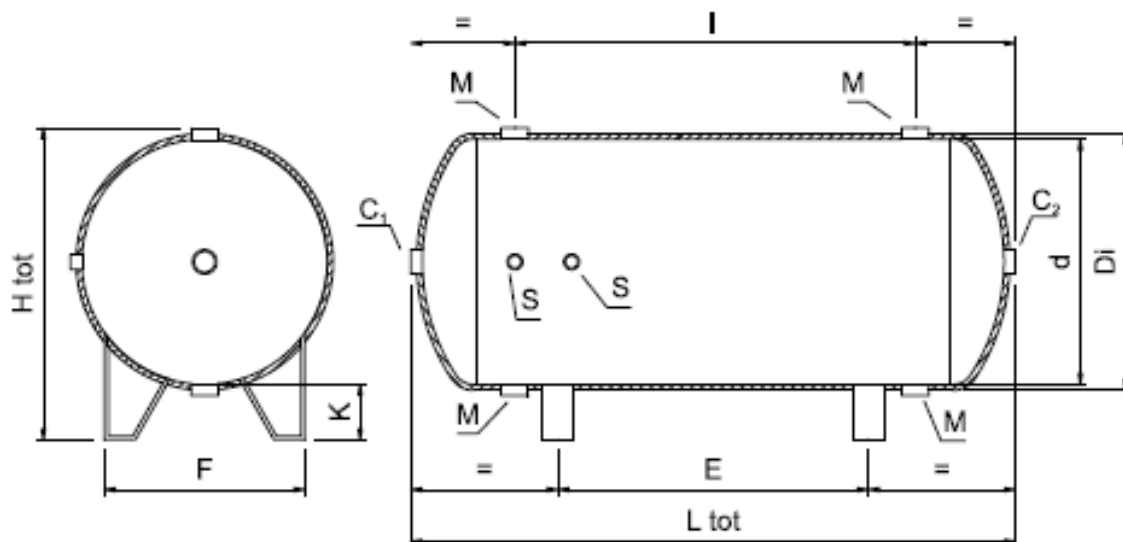

Pos.	Description
M	Water inlet/outlet
C ₁	Pressure relief valve
C ₂	Auxiliary
S	Control instruments

Capacity	Tank dimensions								Fitting diameter		
	Di	d	Htot	Ltot	E	F	K	I	C	M	S
(lt.)	(mm)								(inches)		
100	440	400	535	860	310	300	110	460	1" 1/4	1" 1/2	1/2"
200	490	450	620	1270	610	700	145	840	1" 1/4	1" 1/2	1/2"
300	590	550	715	1320	600	700	140	800	1" 1/4	2"	1/2"
500	690	650	830	1600	900	950	150	1050	1" 1/4	3"	1/2"
750	790	750	925	1890	1130	1200	145	1300	1" 1/2	3"	1/2"
1000	890	850	1020	1930	1130	1200	140	1300	1" 1/2	3"	1/2"
1500	990	950	1165	2320	1080	1500	185	1500	1" 1/2	3"	1/2"
2000	1140	1100	1310	2350	1380	1500	180	1600	2"	3"	1/2"
2500	1240	1200	1440	2410	1380	1500	200	1600	2"	4"	1/2"
3000	1290	1250	1490	2620	1580	1700	200	1800	2"	4"	1/2"
4000	1440	1400	1635	2710	1580	1700	195	1800	2"	4"	1/2"
5000	1640	1600	1825	2770	1580	1700	185	1800	2"	4"	1/2"

Ved forespørgsel kan ekstra muffe/studser tilkøbes



Beholderfabrik & Miljøteknik A/S
- komplet leverandør til industri, service & landbrug